

DEFINITIVE SUBDIVISION

FALCON FARMS

SOUTH STREET

SHREWSBURY, MASSACHUSETTS

JANUARY 31, 2022
 REVISED: MAY 02, 2022
 REVISED: JUNE 07, 2022
 REVISED: SEPTEMBER 19, 2022

OWNER / APPLICANT

Rashid Shaikh, Trustee
 24 Sheryl Drive
 Shrewsbury, MA

CIVIL ENGINEER

DeVellis Zrein Inc
 P.O. Box 307
 Foxboro, MA 02035

SURVEYOR

Precision Land Surveying, Inc.
 32 Turnpike Road
 Southborough, MA 01772

WETLAND SCIENTIST

Goddard Consulting LLC
 291 Main Street
 Northboro, MA

LIST OF DRAWINGS

COVER SHEET	Sheet 2
EXISTING CONDITIONS PLAN	Sheet 3
LOTTING PLAN	Sheet 3
GRADING PLAN	Sheet 4
ROADWAY PLAN AND PROFILE	Sheet 5
EROSION CONTROL PLAN	Sheet 6
PLANTING PLAN	Sheet 7
SITE DETAILS	Sheet 8
SITE DETAILS	Sheet 9
OVERALL GRADING AND DRAINAGE PLAN	Sheet 10

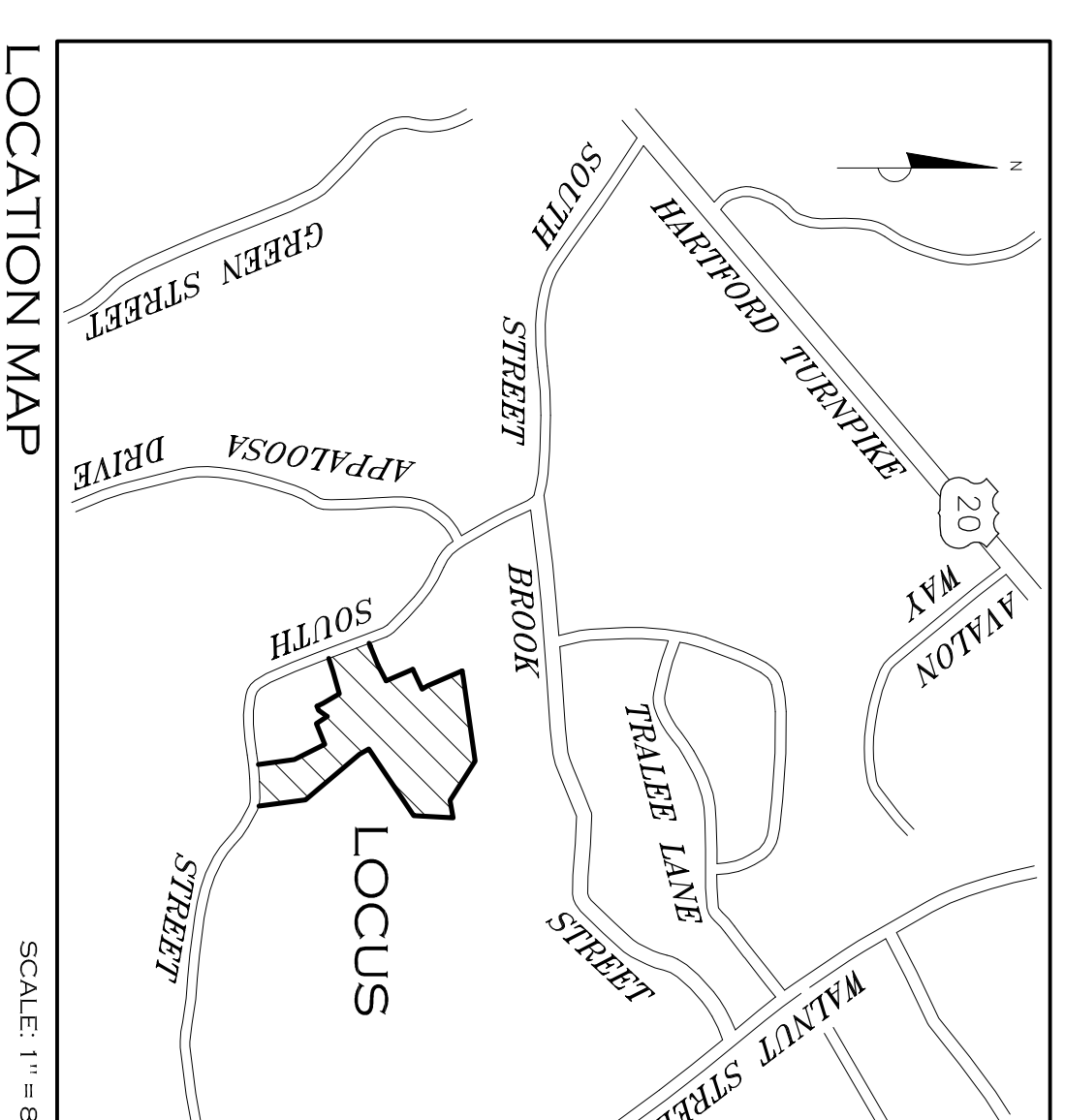

THE PROJECT IS SUBJECT TO THE ORDER OF CONDITIONS ISSUED BY THE TOWN OF SHREWSBURY CONSERVATION COMMISSION DEF-FILE #293-1892

APPROVED _____
 SUBJECT TO THE TERMS AND CONDITIONS OF AN AGREEMENT DATED _____ BETWEEN THE TOWN OF SHREWSBURY PLANNING BOARD AND 7 SHERYL DRIVE REALTY TRUST OR ITS ASSIGNS. THE AGREEMENT IS RECORDED HEREWITH AND IS SUBJECT TO RECORDING IN THE WORCESTER REGISTRY OF DEEDS ON OR BEFORE _____

IN ACCORDANCE WITH MGL C.41, SECTION 81X, SEE THE CERTIFICATE RECORDED AS THE LAST PAGE OF THE DECISION RECORDED AT WORCESTER DISTRICT REGISTRY OF DEEDS IN BOOK 68306, PAGE 393.
 NOTICE OF APPROVAL RECEIVED AND RECORDED DEED BOOK 68306 PAGE 393

TOWN CLERK, SHREWSBURY, MASSACHUSETTS _____

APPROVAL UNDER THE SUBDIVISION CONTROL LAW REQUIRED
 SHREWSBURY PLANNING BOARD

DATE: _____